

# pipa<sup>TM</sup> aire



nuna<sup>®</sup>

# *Thank you!*

You've just purchased a Nuna product, and you can be sure that your child is getting the best there is. Our products are expertly engineered for safety, with luxury fabrics and sophisticated style.

Whatever made you fall in love with Nuna, rest assured your adventures with your little one will be easier from now on, freeing you to enjoy more happy family moments together.

## **Easy Installation**

Our products are designed to make your life easier, so installing this child restraint doesn't require outside assistance. While we encourage the use of Certified Child Passenger Safety Technicians to ensure you have installed the seat correctly, you can install the child restraint in your vehicle without these professionals by carefully reading and following these instructions.



**IMPORTANT!  
KEEP THESE  
INSTRUCTIONS  
FOR FUTURE  
REFERENCE:  
*READ CAREFULLY***

## Contents

About PIPA aire	
<b>Product Information</b>	
Product Registration	4
Recall Information	4
Limited Warranty	5
Contact	5
<b>Child Usage Requirements</b>	5
<b>Warnings</b>	6
<b>Car Seat Use after a Crash</b>	11
<b>Vehicle Compatibility</b>	12
<b>PIPA aire Parts List</b>	16
<b>Base Parts List</b>	18
Using PIPA aire	
<b>Product Overview</b>	20
<b>Product Use</b>	32
<b>Installation</b>	36
Base Installation	36
Child Restraint Only Install	50
In an Aircraft	54
On a Stroller	60
<b>Accessories</b>	60
<b>Cleaning and Maintenance</b>	62

# Product Information

Model Number: \_\_\_\_\_

Manufactured in (date): \_\_\_\_\_

## Product Registration

Please fill in the above information. The model number and the manufactured in date are located on a label on the bottom of your child restraint. Fill out the prepaid registration postcard attached to the seat pad and mail it today.

Child restraints could be recalled for safety reasons. Register your child restraint so you can be notified in case of a recall. Send your name, address, e-mail/phone number if available and the restraint's model number and manufacturing date to:

Nuna Baby Essentials Inc.  
70 Thousand Oaks Blvd.  
Morgantown, PA 19543  
or call 1.855.NUNA.USA

## Recall Information

For recall information, call the U.S. Government's Vehicle Safety Hotline at: 1.888.327.4236 (TTY: 1.800.424.9153) or go to <http://www.NHTSA.gov>

## Limited Warranty

We have purposely designed our high-quality products so that they can grow with both your child and your family. Because we stand by our product, our gear is covered by a custom limited warranty per product, starting from the day it was purchased. Please have the proof of purchase, model number and manufactured in date available when you contact us.

**For warranty information please visit:**  
[www.nunababy.com/warranty](http://www.nunababy.com/warranty)

## Contact

For replacement parts, service, or additional warranty questions, please contact our customer service department.

**In the USA:**  
[infousa@nunababy.com](mailto:infousa@nunababy.com)  
[www.nunababy.com](http://www.nunababy.com)  
1.855.NUNA.USA

## Child Usage Requirements

This child restraint is suitable for use with children who meet the following requirements:

**Weight:** 4–30 lb (1.8–13.6 kg)  
**Height:** 16–30 inches (41–76 cm)

It is recommended to keep your child rear facing as long as possible, until at least 2 years old.

# **⚠️ WARNING**

**DEATH OR SERIOUS INJURY** can occur if you fail to follow the warnings, instructions and labels on the child restraint.

A child's safety is your responsibility. **NEVER** leave your child unattended.

Read all instructions before use of this child restraint or installation in a vehicle. In addition, read the vehicle owner's manual for information on child restraint installation.

Store the instruction manual in the pocket located within the seat pad.

Register your child restraint with the manufacturer.

Secure this child restraint with the vehicle's child restraint anchorage system if available, or with a vehicle belt.

This child restraint can **ONLY** be used in a rear facing position when using in a vehicle. This child restraint cannot be properly secured in a forward facing position and will be unsafe.

Use only with children who weigh between 4 and 30 pounds (1.8 and 13.6 kg) and whose height is between 16 and 30 inches (41 and 76 cm). Exceeding these height and weight limits is unsafe.

Snugly adjust the belts provided with this child restraint around your child. If straps are not snugly adjusted, child may be ejected from seat in the event of an accident.

A snug strap should not allow any slack. It lies in a relatively straight line without sagging. It does not press on the child's flesh or push the child's body into an unnatural position.

Cover the child restraint when your vehicle is parked in sunlight. Parts of a child restraint can become very hot if left in the sun, and can burn a child's skin. Check for hot parts before putting your child in the child restraint.

**EXPIRATION DATE** Check the label on the underside of the base or child restraint for expiration date information.

**NEVER** use a car seat that has been involved in a moderate to severe crash. **See page 11** to learn what is classified as a moderate to severe crash.

### **STRANGULATION HAZARD**

Children have **STRANGLLED** in loose or partially buckled harness straps. Fully restrain the child even when carrier is used outside the vehicle.

**FALL HAZARD** Child's activity can move carrier. **NEVER** place carrier on counter tops, tables, or any other elevated surface. Always stay within arms reach whenever carrier is not on floor/ground. Be sure handle locks into position before lifting carrier.

The carrier can fall from a shopping cart. **DO NOT USE** on a shopping cart.



### **SUFFOCATION**

**HAZARD** Infant carrier can roll over on soft surfaces and suffocate child. **NEVER** place carrier on beds, sofas, or other soft surfaces.

**ALWAYS** check child restraint to base connection.

**DO NOT** allow anyone who has not read the instruction manual to install or use this child restraint.

**DO NOT** allow child restraint or handle to contact the vehicle interior (side of car door or seat in front) when installed on base.

**DO NOT** use child restraint if it has frayed or cut harness straps, or is damaged in any way. To find out if damaged parts are replaceable, call 1-855-NUNA-USA.

**NEVER** modify any part of the child restraint.

**DO NOT** use any products or accessories with this child restraint unless they are approved by Nuna for use with this child restraint. Doing so may be unsafe and may void the warranty.

**NEVER** leave child restraint and base in vehicle when uninstalled, even when unoccupied. In a crash, it could become a projectile and injure other vehicle occupants.

**NEVER** use clothing or blankets that interfere with providing a properly tightened harness. An unsecured or improperly harnessed child can come out of the restraint during a crash. Place blankets over child **AFTER** harness has been properly tightened.

Only use with Nuna strollers or appropriate Nuna adapters designed for use with other strollers.

## Car Seat Use after a Crash

The National Highway Traffic Safety Administration (NHTSA) recommends that car seats be replaced following a moderate or severe crash. Car seats do not automatically need to be replaced following a minor crash.

### What defines a minor crash?

A minor crash is one in which **ALL** of the following apply:

- The vehicle was able to be driven away from the crash site.
- The vehicle door nearest the car seat was not damaged.
- None of the passengers in the vehicle sustained any injuries in the crash.
- If the vehicle has air bags, none of the air bags deployed during the crash; and
- There is no visible damage to the car seat.

**NEVER** use a car seat that has been involved in a moderate to severe crash. Contact Nuna with questions or concerns about your seat.

*Information from [nhtsa.gov](http://nhtsa.gov)*

# Vehicle Compatibility

You **MUST** read and understand **ALL** child restraint related instructions and warnings in your vehicle owner's manual to correctly and safely use this child restraint in your vehicle.

This child restraint can **ONLY** be installed on vehicle seats that face forward and **MUST** be installed in a vehicle with the base. **DO NOT** install in seats that face to the sides or rear of the vehicle.

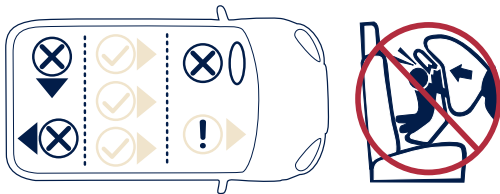

**NEVER** install this child restraint rear facing in a vehicle seating position with a frontal air bag unless it is turned off. Airbags inflate with great force and can cause severe injury to a child's neck and spine. If your vehicle is equipped with passenger side air bags, check your vehicle owner's manual for child restraint installation instructions.

According to accident statistics, children are safer when properly restrained in the rear seating positions than in the front seating positions.

This child restraint was designed for use in an automobile **ONLY**. **DO NOT** attempt to use it on any other type of vehicle.

*(continued on the next page)*

Refer to your vehicle owner's manual to determine if the belts in your vehicle lock by switching the seat belt's retractor **OR** if they have a locking latch plate that locks the vehicle's seat belt so they will hold the child restraint tightly without loosening.

The following vehicle belts **CAN NOT BE USED** with your child restraint:

- 1 - Motorized Belts (Automatic)**  
This belt cannot be used to install this child restraint.
- 2 - Dual Retractor Belts**  
This belt cannot be used to install this child restraint.
- 3 - Lap Belts** cannot be used.
- 4 - Airbag/Inflatable Belts**  
This belt cannot be used to install this child restraint.
- 5 - Door Mounted Belts**  
This belt cannot be used to install this child restraint.

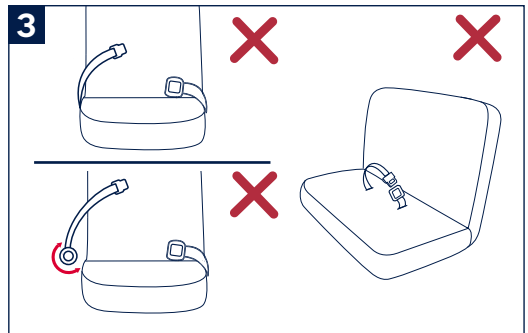
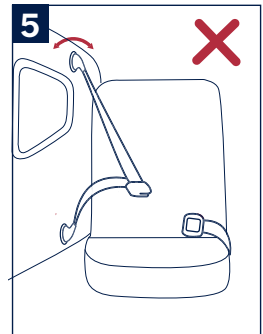
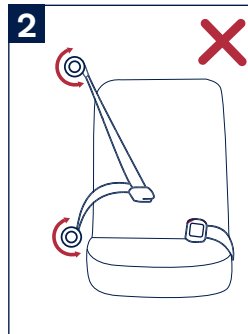
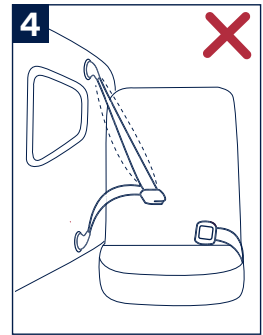
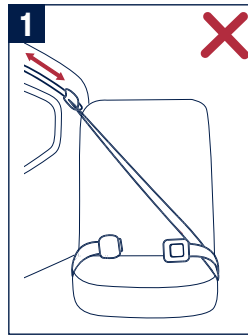

# PIPA aire Parts List

Make sure all parts are available before assembly. If any part is missing, please contact Nuna (see page 5 for information). No tools are required for assembly.

- 1 Canopy
- 2 Seat Pad
- 3 Body Support
- 4 Chest Clip
- 5 Buckle and Crotch Pad
- 6 Harness Adjustment Button
- 7 Harness Adjustment Strap
- 8 Lap Belt Guide
- 9 Instruction Manual Pocket
- 10 Handle Adjustment Button
- 11 Stroller Release Button\*
- 12 Canopy Release Button
- 13 Sky Drape™ Zipper
- 14 Shoulder Harness Pads
- 15 Head Support
- 16 Handle
- 17 Stroller Release Button\*\*
- 18 Harness Slots
- 19 Base Attachment Bar
- 20 Harness Straps
- 21 Shoulder Harness Loop
- 22 Splitter Plate
- 23 Base Attachment Bar

\*Only used with infant car seat post adapters

\*\*Only used with infant car seat ring adapters

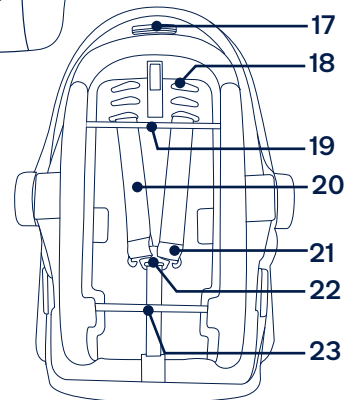
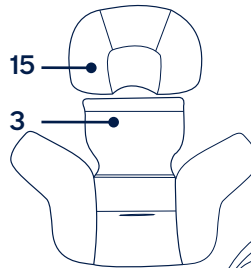
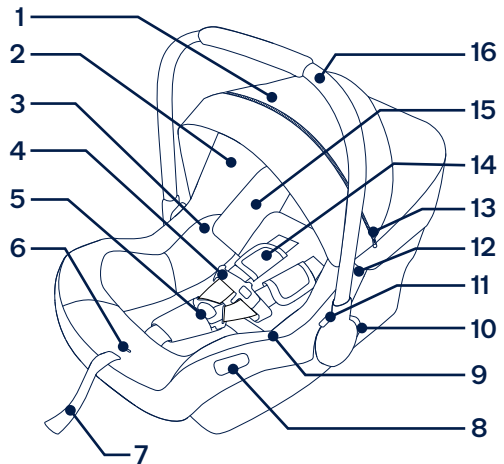

# Base Parts List

Make sure all parts are available before assembly. If any part is missing, please contact Nuna (see page 5 for information). No tools are required for assembly.

- 1 Vehicle Belt Lock Off
- 2 Rigid Lower Anchor Attachment
- 3 Primary Rigid Lower Anchor Attachment Release Button
- 4 Secondary Rigid Lower Anchor Attachment Release Button
- 5 Rigid Lower Anchor Attachment Guides
- 6 Stability Leg
- 7 Level Indicator
- 8 Carrier Release Button
- 9 Stability Leg Adjustment Button
- 10 Stability Leg Indicator
- 11 Stability Leg Storage
- 12 Recline Adjustment

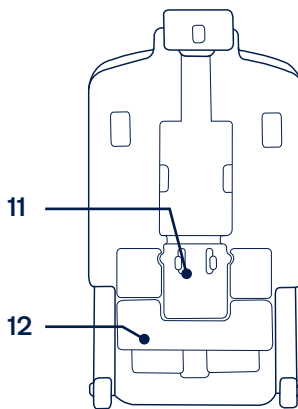
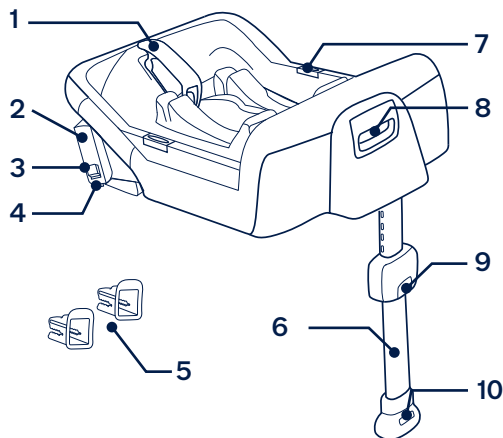

# Product Overview

## Canopy

- 1 - To attach the canopy, snap the canopy to the canopy mount on both sides. To open the canopy, pull the canopy toward the front of the seat, and to close the canopy, push it back.
- 2 - To remove the canopy, first undo the snap on the canopy mount (reverse step 1).
- 3 - Then press the canopy release button (1) and pull the canopy out of the canopy mount (2).  
Repeat on opposite side.

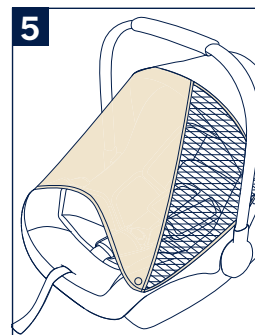
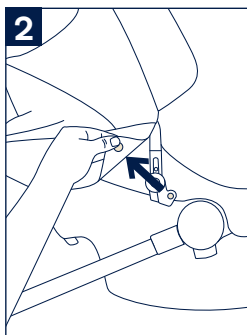
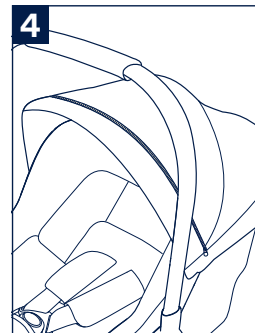
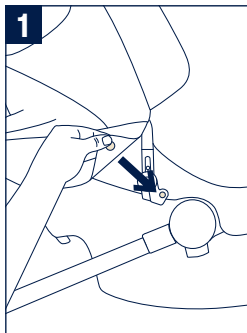

## Sky Drape

- 4 - Unzip the zipper behind the front canopy bow.
- 5 - Pull the Sky drape out of the compartment.

Attach the Sky drape to the magnets on each corner to the front of the carrier.

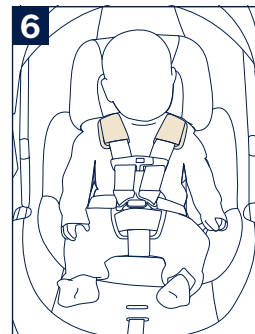
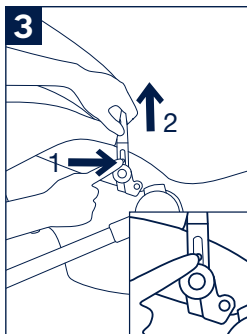

## Shoulder Harness Pads

- 6 - Shoulder harness pads are removable. Unfasten the hook and loop to remove the shoulder harness pads.
- ⚠** Shoulder harness pads **MUST** be removed once the child reaches 22 lb.

## Crotch Pad

- 1 - Unbuckle the harness and locate the crotch pad strap.
  - 2 - Keep the tab at the end of the crotch pad strap flat against the strap and then route the crotch pad strap through the front of the buckle.
  - 3 - Pull the crotch pad off the buckle.
- ⚠** Crotch pad **MUST** be removed once the child reaches 22 lb.

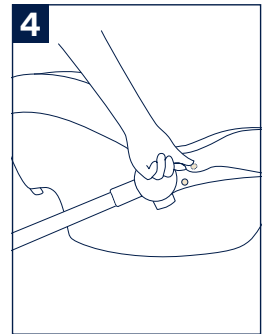
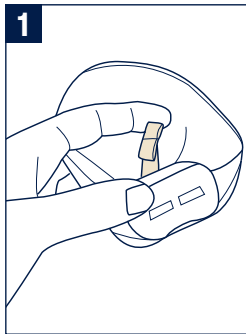

## Seat Pad

- 4 - Open the snaps on both sides of the seat.
- 5 - Turn child restraint over and remove the harness straps from the splitter plate.
- 6 - Remove the seat pad.

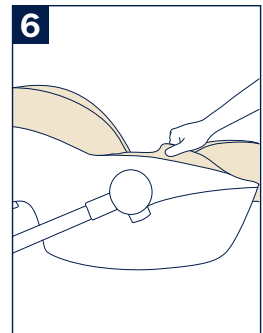
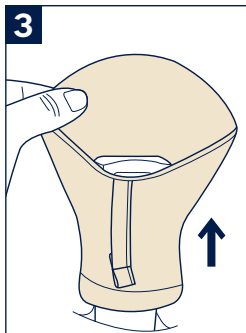
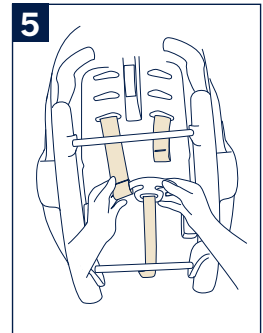
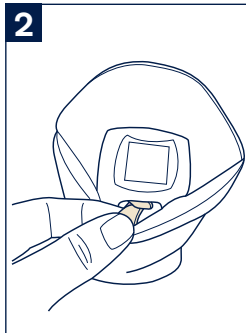

## Head and Body Support

The head and body supports can be used as necessary, to provide a snug fit for small babies.

**⚠** The head support straps cannot go through the same slots as the harness and should only be used in the top two harness slot positions.

- 1 - To remove the head support, unfasten the hook and loop ends behind the seat fabric.
- 2 - Then, pull the head support straps through the harness slots.
- 3 - To remove, the body support, unbuckle the harness and route the buckle and crotch belt through the bottom slot of the body support.
- 4 - The low birth weight pillow (located on the back of the body support) can be used in the body support for even smaller babies, but **MUST** be removed once a snug fit can be achieved without it, at approximately 11 lb.
- 5 - To remove the low birth weight pillow, unfasten the hook and loop on the back of the body support and pull out the pillow.

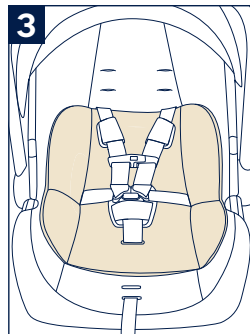
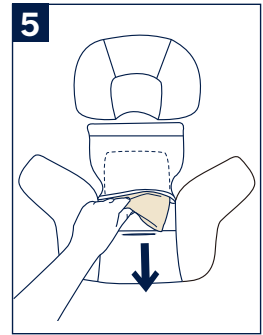
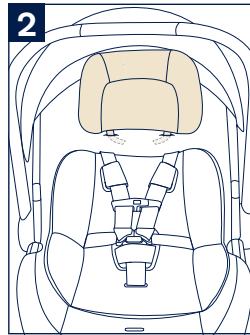
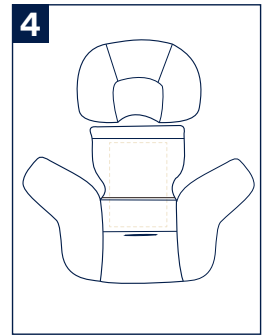
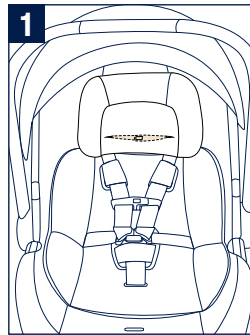

## Shoulder Belts

- 1 - Tighten harness to fit snugly on child's shoulders. It is snug if you cannot pinch a fold in the strap.
- 2 - Harness straps must be at or just below shoulders.
- 3 - To adjust shoulder harness height, remove child and loosen harness by pressing the harness adjustment button (1) while pulling on the harness strap (2). The harness adjustment button is located inside the slot on the seat pad.
- 4 - Turn child restraint over and remove one harness loop from metal splitter plate.
- 5 - Pull loose ends of harness loop out through slots and place in correct slot.
- 6 - Repeat process for second shoulder harness strap and then re-attach harness to splitter plate.

*(continued on the next page)*

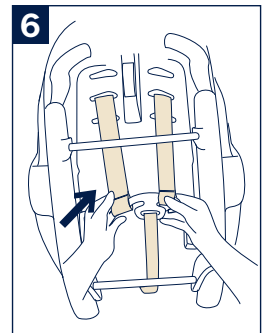
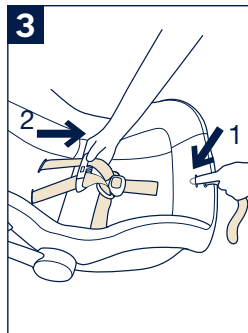
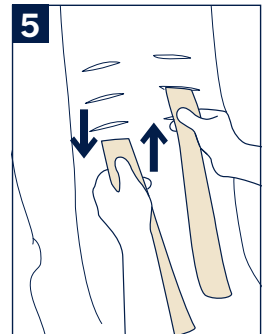
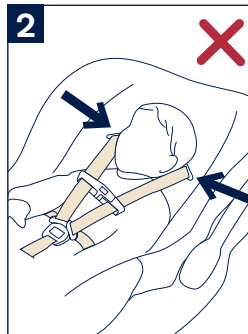
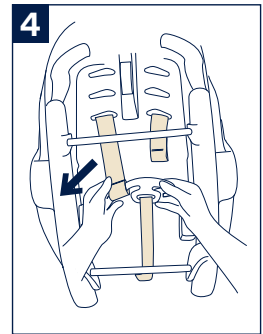
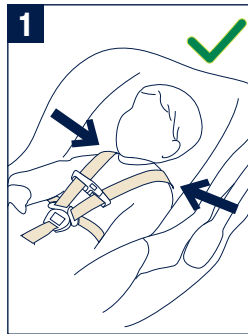

## Shoulder Belts (continued)

- 1 - **⚠ DO NOT** allow harness to pass over base attachment bars.
- 2 - Top of child's head is at least 1" below top of child restraint.

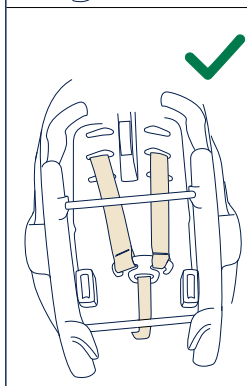
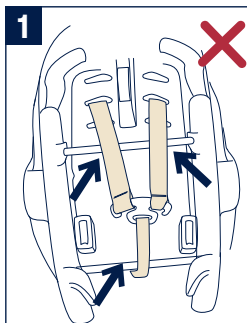

## Handle Adjustment

**1** - To adjust the handle position, squeeze handle buttons on both sides. **(1)**

Rotate handle until it clicks into a locked position. **(2)**

**2** - The handle has 3 locked positions (including carry position).

**!** Be sure handle is **locked in the carry position** before lifting child restraint by handle. An unlocked handle could move unexpectedly, causing injury to child.

Nuna recommends to have the handle in the carry position when in the vehicle. This allows space between front/rear seats and easier install/removal of the carrier.

**!** Handle **MUST NOT** contact the vehicle interior (side of car or seat in front) when installed.

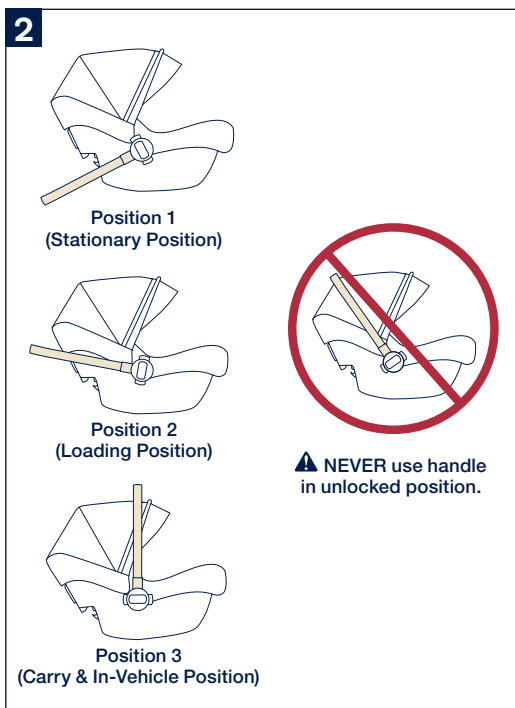
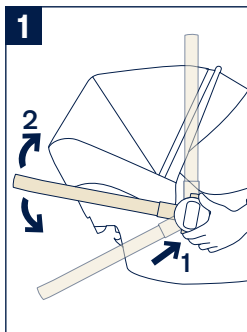

# Product Use

## Securing Child in Child Restraint

- 1 - Loosen harness by pressing the harness adjustment button (1) while pulling on the harness straps (2). The harness adjustment button is located inside the slot on the seat pad.
- 2 - Press button to release the halves of the chest clip. (1) Separate chest clip and spread harness straps apart. (2) Press buckle button and remove buckle tongues. (3)
- 3 - Place child in child restraint in seated position. The child should be seated against both the back and bottom of the seat with no gap behind the child. Do not allow child to slouch.
- 4 - Insert buckle tongues into buckle and listen for clicks. Pull on buckle to verify it is latched.
- 5- Snap the chest clip together and temporarily slide towards buckle for tightening of harness.

*(continued on the next page)*

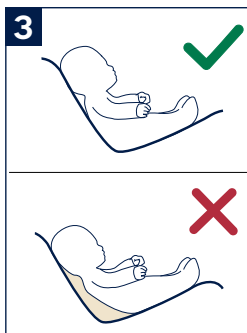
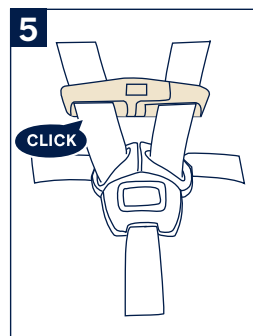
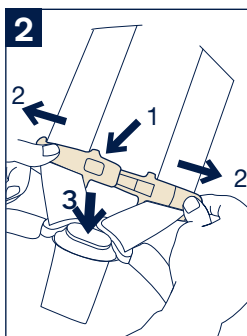
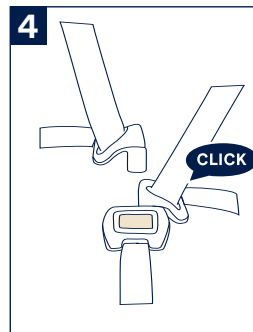
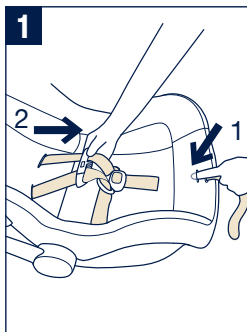

## Securing Child (continued)

- 1 - Slide excess strap from the child's waist up through the buckle towards the shoulders (1). Pull harness adjuster strap to remove slack in harness (2). Slide chest clip so it is level with child's armpit (3). This may need to be repeated several times for proper fit.
- 2 - Repeat step 1 until harness is snug. When snug you should NOT be able to pinch a fold in the harness.

### Check that Child is Secure

- Buckle is fastened.
- Harness straps are not twisted.
- Harness is snug – A snug harness cannot be pinched, and should not allow any slack.
- Chest clip is level with armpits.
- If child weighs 22 lb or more, shoulder & crotch pads have been removed.

- 3 - **⚠** Harness straps must be at or just below child's shoulders to avoid injury. If harness slots need to be moved, see shoulder belts section.  
**⚠** Make sure that nothing interferes with the harness. Make sure harness is snug around child and lays flat.  
**⚠** If child is not secured properly, child could be ejected in a sudden stop or crash, resulting in serious injury or death.

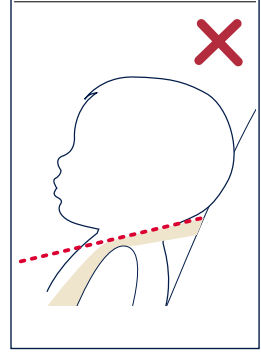
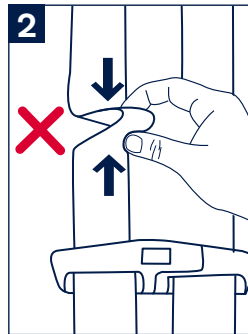
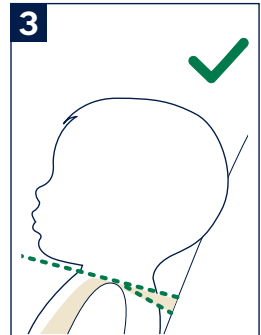
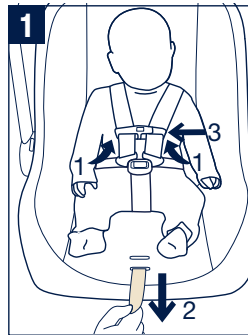

# Installation

**!** If child is not secured properly, child could be ejected in a sudden stop or crash, resulting in serious injury or death.

## Base Installation Using Rigid Lower Anchor Attachments

- 1 - Place vehicle in park and on level ground.
- 2 - Position base in a forward facing vehicle seat. Adjust base so bubble touches line.
- 3 - If necessary, use recline adjustment to position bubble in level indicator to achieve correct angle for installation. Recline adjustment locks into position.
- 4 - To release recline adjustment, press down on lock button located under base.
- 5 - If necessary, install rigid lower anchor attachment guides on vehicle lower anchors.

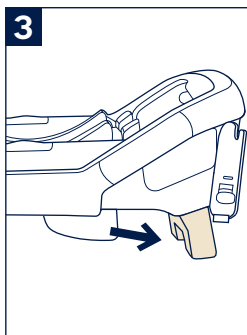
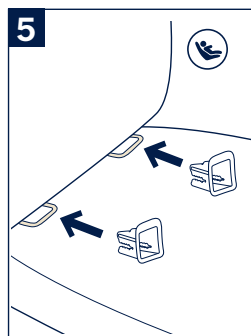
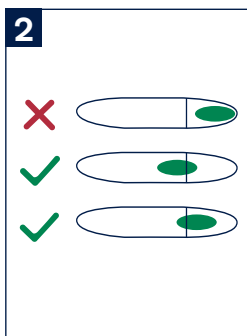
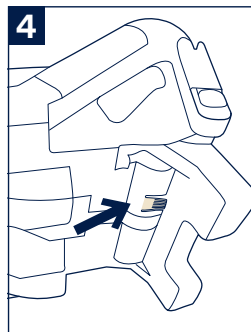
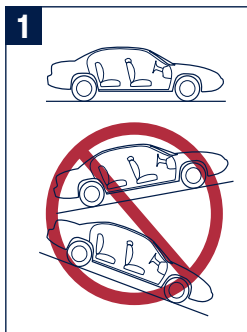

- 1 - Rotate rigid lower anchor attachments down.
- 2 - Hook rigid lower anchor attachments onto vehicle lower anchors.
- 3 - Confirm proper installation by pulling on the base **AND** also seeing that green is indicated on the connectors.

**!** The rigid lower anchor attachment must be attached and locked onto the vehicle anchors.

Additional stability can be achieved with the base by using the stability leg. For instructions on using the stability leg, see stability leg section (p.48).

### Check the Installation

- Base should not move side to side or forward more than 1" at belt path.
- Bubble must be touching line. Use recline adjustment, if needed, to position bubble.

It is acceptable to install with both lower anchor attachment and the vehicle belt.

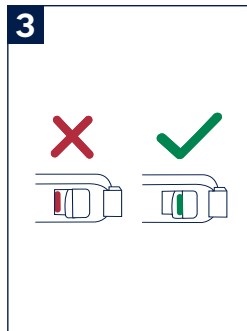
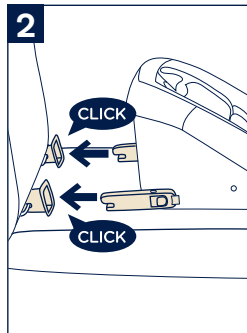
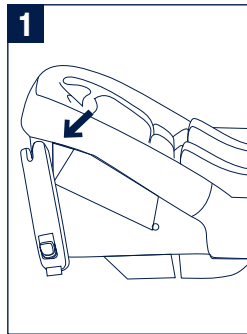

## Attaching Child Restraint to Base

- 1 - After child is properly secured in child restraint, press child restraint on base and listen for a click. Pull on child restraint to verify installation.

**⚠ DO NOT** allow child restraint or handle to contact the vehicle interior (side of car door or seat in front) when installed on base.

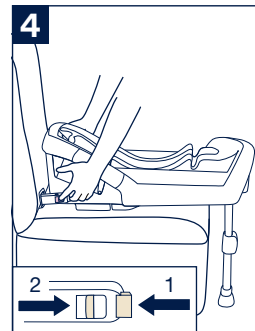

## Releasing Child Restraint from Base

- 2 - To release the child restraint, squeeze the carrier release button (1) located on the base and then pull the child restraint up (2).

## Uninstalling Base (when Installed with Rigid Lower Anchor Attachments)

- 3 - To remove the base, first push the base toward the vehicle seat with a light force.
- 4 - As you push the base toward the vehicle seat, squeeze the secondary (1) and primary rigid lower anchor attachment release buttons (2). For ease of release, push the secondary button first, then the primary button.
- 5 - Then pull the base off of the vehicle lower anchors.

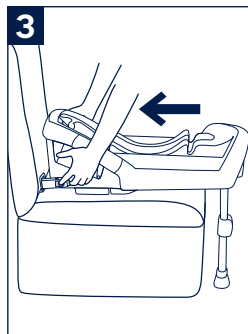
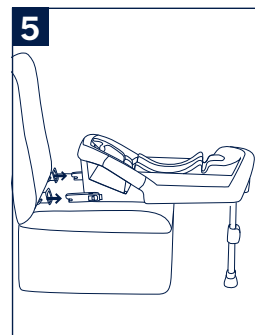
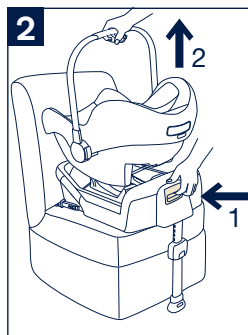

## Base Installation Using Vehicle Belt (Lap/Shoulder Belt)

- 1 - Place vehicle in park and on level ground.
- 2 - Position base in a forward facing vehicle seat. Adjust base so bubble touches line.
- 3 - If necessary, use recline adjustment to position bubble in level indicator to achieve correct angle for installation. Recline adjustment locks into position.
- 4 - To release recline adjustment, press down on lock button located under base.
- 5 - Open the vehicle belt lock off by lifting up.
- 6 - Route the vehicle belt through the opening in the base labeled 'belt here' and under the vehicle belt lock off.

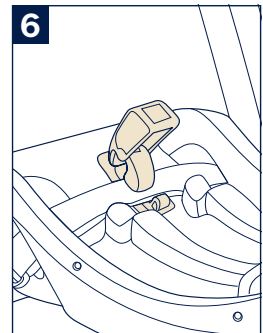
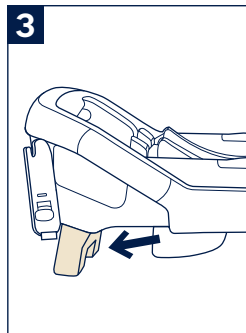
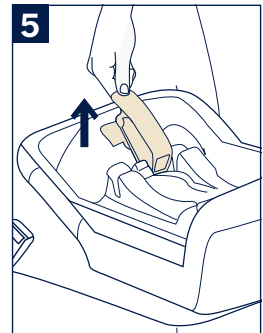
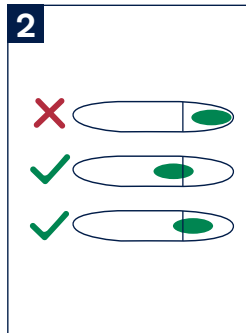
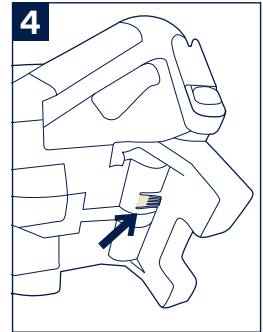
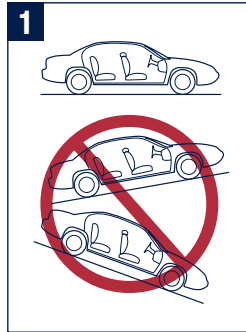

- 1 - Buckle the vehicle belt. Both the shoulder **AND** lap belt must be under the vehicle belt lock off and belts must lay flat.
- 2 - While pressing the base into the vehicle seat (1), tighten the vehicle belt by pulling straight along the belt path (2).
- 3 - While the shoulder belt is tight, hook the bottom of the vehicle belt lock off (1) and press to close (2).

Additional stability can be achieved with the base by using the stability leg. For instructions on using the stability leg see stability leg section (p.48).

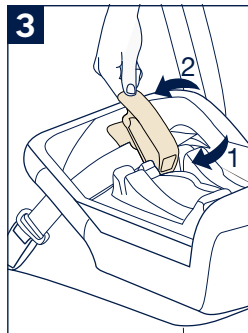
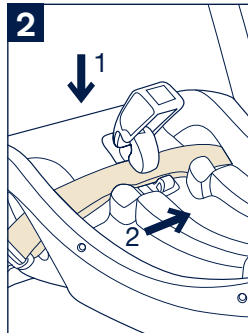
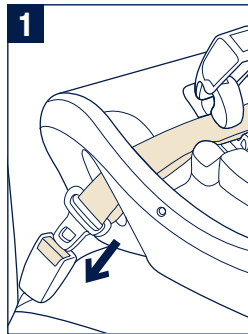

### Check the Installation

- Belts must be tight.
- Base should not move side to side more than 1" at belt path.
- Bubble must be touching line.
- Belts and buckles must not interfere with attachment of child restraint to base.
- Vehicle belts must lay flat under vehicle belt lock off.

It is acceptable to install with both rigid lower anchor attachments and the vehicle belt.

## Attaching Child Restraint to Base

- 1 - After child is properly secured in child restraint, press child restraint on base and listen for a click. Pull on child restraint to verify installation.

**⚠ DO NOT** allow child restraint or handle to contact the vehicle interior (side of car door or seat in front) when installed on base.

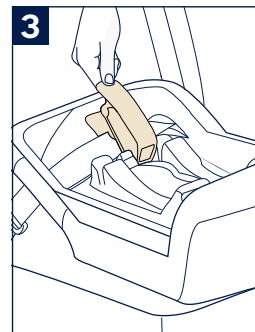

## Releasing Child Restraint from Base

- 2 - To release the child restraint, squeeze the carrier release button (1) located on the base and then pull the child restraint up (2).

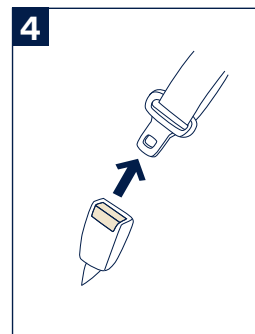
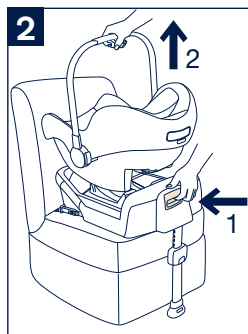

## Uninstalling Base (when Installed with Vehicle Belt)

- 3 - To remove the base, lift up on the vehicle belt lock off.
- 4 - Unbuckle the vehicle belt and un-route the shoulder and lap belt from the base.  
Then remove the base.

## Stability Leg

Refer to vehicle owner's manual to determine if stability leg can be used over a vehicle storage compartment.

- 1 - Unfold the stability leg from the stability leg storage.
- 2 - After correctly installing the base on the vehicle seat, press the stability leg adjustment button to extend the stability leg to the floor.
- 3 - Stability leg should make firm contact with the vehicle floor.
- 4 - Indicators should show green.

**⚠** When the stability leg indicator shows red, this means the stability leg is in the wrong position. Make sure the stability leg is secure and makes firm contact with the vehicle floor. The stability leg indicator shows green when it is properly contacting the floor of the vehicle.

- 5 - **DO NOT** use if stability leg lifts base off seat.

**⚠** **DO NOT** use stability leg to recline the base. The recline adjustment feature is meant to recline the base.

Always store stability leg when not in use.

This seat is safe to use with stability leg in use or stored for both rigid lower anchor attachment or vehicle belt installation.

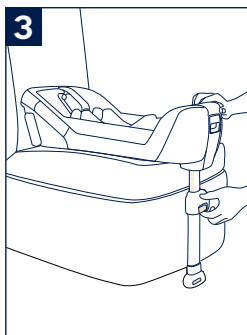
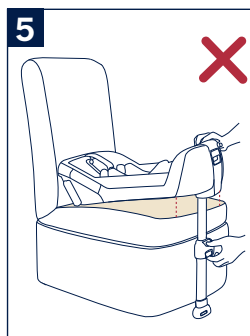
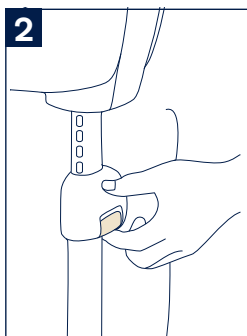
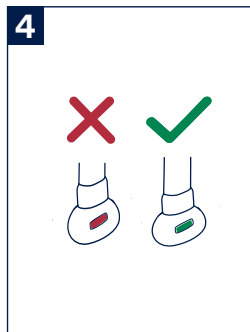
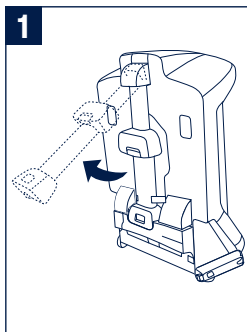

## Child Restraint Only Install

This child restraint can be installed without a base in 2 different ways.

**1** - Place vehicle in park and on level ground. Position child restraint so that child is facing the rear of the vehicle.

**⚠** Only install in a forward facing vehicle seat.

**2** - **Option 1:** Route the vehicle lap belt under both lap belt guides. Buckle the vehicle belt. Allow shoulder belt to lay against vehicle seat back as shown.

**3** - **Option 2:** Route the vehicle lap belt under both lap belt guides. Buckle the vehicle belt. Route the shoulder belt around the back of the child restraint passing through the blue shoulder belt guide.

**4** - Adjust the angle of the child restraint. A rolled up towel or foam pool noodle may be used to adjust the amount of recline.

**5** - Angle is correct when blue line on child restraint (located on the label on the side of the child restraint) is level with ground.

*(continued on the next page)*

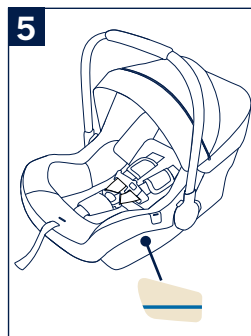
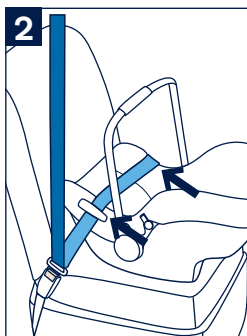
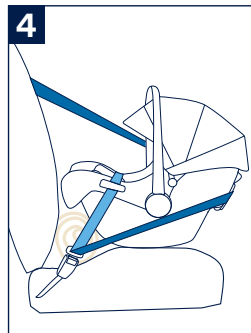
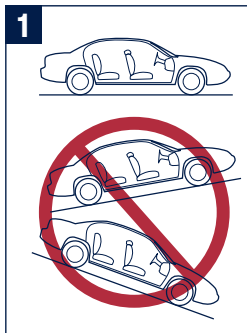

## Child Restraint Only Install (continued)

- 1 - Tighten vehicle belt while pushing child restraint firmly into vehicle seat. **Lock the vehicle belt.** Refer to vehicle owner's manual for instructions. If you cannot lock the vehicle belt, you must use a locking clip (see note below).

Tension the vehicle belt as much as possible, checking that it is not loose or twisted.

**If you need a locking clip, contact  
Nuna Customer Service:**

By phone: 1.855.NUNA.USA

By email: [infousa@nunababy.com](mailto:infousa@nunababy.com)

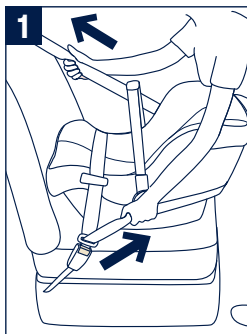

### Check Installation

- Blue line on label must be level with ground.
- Vehicle belt must be buckled, tight and must stay locked.
- Child restraint should be stable and not move side to side more than 1 inch at belt path.

## Installation in an Aircraft

Position child restraint so that child is facing the aircraft seat back.

- 1** - Route the aircraft lap belt under both lap belt guides and buckle.
- 2** - Adjust the angle of the child restraint. The angle is correct when the blue line is level with the floor of the aircraft.

Tighten the aircraft belt while pushing the child restraint firmly into the seat.

This child restraint is certified for use in commercial aircraft with or without the base. Be sure to contact your airline prior to travel to discuss their use policy.

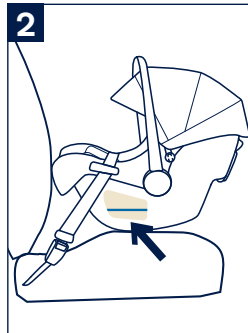
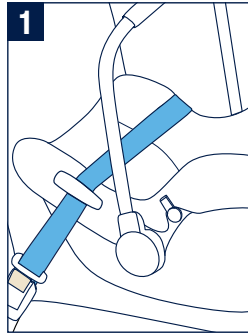

## Aircraft installation with a base using airplane lap belt

Nuna does not recommend using the stability leg on an aircraft.

- 1 - Position base in a forward facing aircraft seat. Adjust base so bubble touches line.
- 2 - If necessary, use recline adjustment to position bubble in level indicator to achieve correct angle for installation (p.42). Recline adjustment locks into position.
- 3 - Open the vehicle belt lock off by lifting up.
- 4 - Route the vehicle belt through the opening in the base labeled 'belt here' and under the vehicle belt lock off.
- 5 - Buckle the aircraft belt. Lap belt must be under the vehicle belt lock off and belts must lay flat.
- 6 - While pressing the base downward into the aircraft seat (1), tighten the aircraft belt by pulling straight upward on the aircraft belt (2).

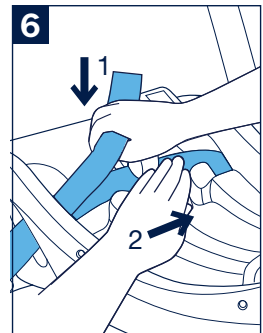
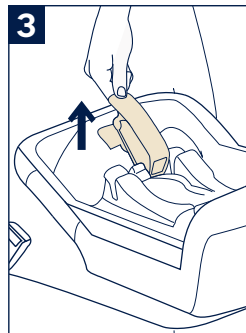
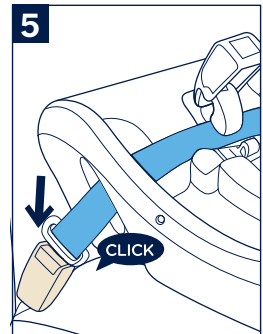
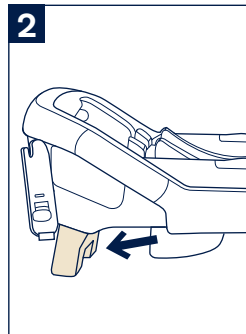
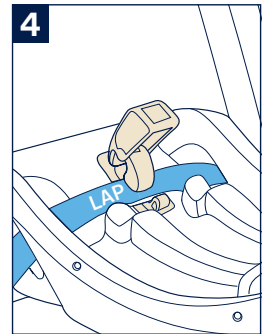
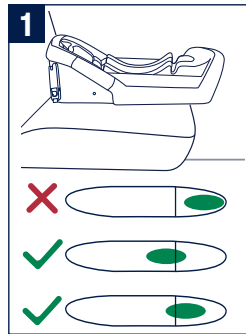

## Aircraft installation with a base using airplane lap belt

(continued)

1 - Push down on the lock off to close it.

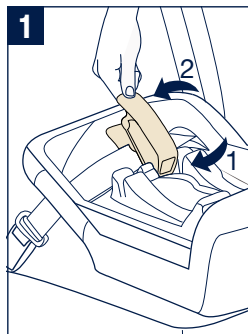

### Check the Installation

2 - Test the security of the installation **near the belt path (a)**, not at **the end of the base (or seat) (b)**.

- Base should not move side to side more than 1" **at the belt path**.
- Belt must be tight.
- Belt and buckle must not interfere with attachment of child restraint to base.
- Aircraft belt must lay flat under lock off.
- There should be no gap between the vehicle seat and the bottom of the base.

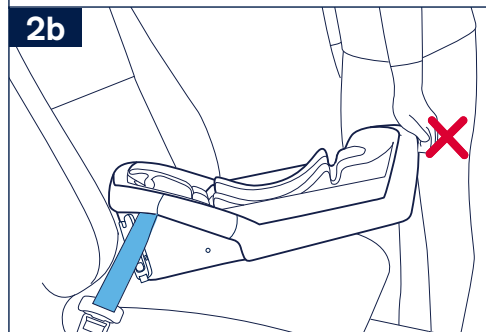

## Installation on a Stroller

This infant carrier can attach to Nuna strollers as well as other brands of strollers using adapters\* (see next page). Adapter is sold separately. Visit [nunababy.com](http://nunababy.com) for more information.

## Accessories

### PIPA series adapters

The PIPA aire can attach to Nuna strollers\* using adapter. Instructions are included with the adapter, which are sold separately.

#### 1 - Infant Car Seat Ring Adapter

This infant carrier can also attach to other brands of strollers using adapters. Please visit [nunababy.com](http://nunababy.com) for more information.

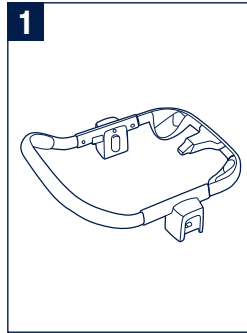

\*Attaches to Nuna TAVO™ series without adapters

# Cleaning and Maintenance

Refer to the care label attached to the soft goods for washing and drying instructions.

**DO NOT** attempt to remove the foam under the seat pad.

Use only mild detergent, water and a soft cloth to clean the infant carrier shell, handle and harness straps. Air dry.

To clean the buckle: rinse using warm water. **DO NOT** use any soaps, solvents or lubricants. Using anything other than water can cause the buckle to malfunction. Air dry.

Remove the infant carrier from the vehicle seat if not in use for a long period of time. Put the infant carrier in a cool, dry place and somewhere your child can not access it.

It is normal for fabric to color from sunlight and to show wear and tear after a long period of use, even when used normally.

Check regularly if everything functions properly.

If any parts are torn, broken, or missing, stop using this product.

Nuna Baby Essentials, Inc. Nuna and all associated logos are trademarks.

IM-001750B



**Nuna Baby Essentials, Inc.**

**70 Thousand Oaks Blvd. | Morgantown, PA 19543**

**1.855.NUNA.USA | [nunababy.com](http://nunababy.com)**