

pipaTM urbn flex system



nuna[®]



Thank you!

You've just purchased a Nuna product, and you can be sure that your child is getting the best there is. Our products are expertly engineered for safety, with luxury fabrics and sophisticated style. Whatever made you fall in love with Nuna, rest assured your adventures with your little one will be easier from now on, freeing you to enjoy more happy family moments together.



**IMPORTANT!
KEEP THESE
INSTRUCTIONS FOR
FUTURE REFERENCE:**
READ CAREFULLY

Contents

Product Information

Product Registration (US consumers only)	4
Limited Warranty	4
Contact	5

Child Usage Requirements

5

Warnings

6

Parts List

10

Product Setup and Fold

12

Product Use

14

Cleaning and Maintenance

20

Product Information

Model Number: _____

Manufactured in (date): _____

Product Registration (For US consumers only)

Please fill in the above information. The model number and the manufactured in date are located on a label on the stroller frame. Fill out the prepaid registration postcard attached to the product and mail it today.

To register your product, please visit:

www.nunababy.com

Click on the “Register Gear” link on the homepage.

Limited Warranty

We have purposely designed our high-quality products so that they can grow with both your child and your family. Because we stand by our product, our gear is covered by a custom limited warranty per product, starting from the day it was purchased. Please have the proof of purchase, model number and manufactured in date available when you contact us.

For warranty information please visit:

www.nunababy.com/warranty

Contact

For replacement parts, service, or additional warranty questions, please contact our customer service department.

In the USA:

infousa@nunababy.com

www.nunababy.com

1.855.NUNA.USA

Child Usage Requirements

When using the stroller frame with Flex System stroller seat (sold separately), stroller is suitable for use with children who meet the following requirements:

Weight: up to 50 lb maximum (22.7 kg)

Height: up to 45 inches (114.3 cm)

When using the stroller frame with a PIPA™ series infant carrier or the bassinet, refer to the child usage requirements listed in those instruction manuals.

⚠️ WARNING

Failure to follow these warnings and instructions could result in serious injury or death.

A child's safety is your responsibility. **NEVER** leave your child unattended.

To avoid any danger of suffocation, remove all plastic covers before using the stroller and destroy or keep away from babies and children!

Keep small parts away from children as they pose a choking hazard.

Discontinue using the stroller if it becomes damaged or broken.

DO NOT make any changes or modifications to the stroller that are not specified in this manual.

Use original Nuna parts and accessories only.

Overloading, incorrect folding, and using accessories other than those approved by Nuna, e.g. child seats, bag hooks, rain covers, buggy boards, etc., may damage or make the stroller unsafe.

USE OF THE STROLLER FRAME with the Flex System stroller seat (sold separately) and a child weighing more than 50 lb (22.7 kg) or taller than 45 inches (114.3 cm) in height will cause excessive wear and stress on the stroller, and could create an unstable condition. Use the stroller with only one child at a time.

When using the stroller frame with a PIPA™ series infant carrier or the bassinet, refer to the child usage requirements listed in those instruction manuals.

To prevent a hazardous, unstable condition, do not place more than 22 lb (10 kg) in storage basket (including in pocket) and never place purses, shopping bags, parcels or other items on the handle or canopy.

DO NOT use the Nuna Sling bag or Stroller organizer with this stroller.

Avoid serious injury from falling or sliding out. **ALWAYS** use seat belt. After fastening buckles, adjust belts to get a snug fit around your child.

AVOID FINGER ENTRAPMENT Use care when folding and unfolding the stroller. Be certain the stroller is fully erected and locked before allowing your child near the stroller.

STRANGULATION HAZARD Do not place items with a string around your child's neck, suspend strings from the stroller, or attach strings to toys.

DO NOT let your child play with the stroller.

ALWAYS keep your child in view while in the stroller.

NEVER allow your child to stand on the stroller.

The parking brake **MUST** be engaged when the stroller is stopped and when placing and removing child.

Negotiate curbs and rough ground carefully. Repeated impact could cause damage to the stroller.

The stroller is to be used only at walking speed and is not intended for use while jogging, skating, etc.

NEVER use the stroller on stairs or escalators. You may suddenly lose control of the stroller or your child may fall out.

The stroller does not replace a crib or a bed. Should your child need to sleep, they should be placed in a crib or sleeping area based on your child's requirements.

ALWAYS allow the fabric to dry naturally away from direct heat.

DO NOT leave the stroller in the vicinity of a strong source of heat, i.e. a radiator or open fire, or store the stroller in a damp place.

NOTE

Parts List

Make sure all parts are available before assembly.
If any part is missing, please contact Nuna (see page 5 for information). No tools are required for assembly.

- 1 Handle
- 2 Handle Adjustment Button
- 3 Folding Button
- 4 Tracking Device Pocket
- 5 Front Wheel
- 6 Rear Wheel
- 7 Storage Basket
- 8 Brake Lever
- 9 Carry Bag
- 10 Adapter Release Button
- 11 Car Seat Ring Adapter
- 12 Adapter Fold Strap

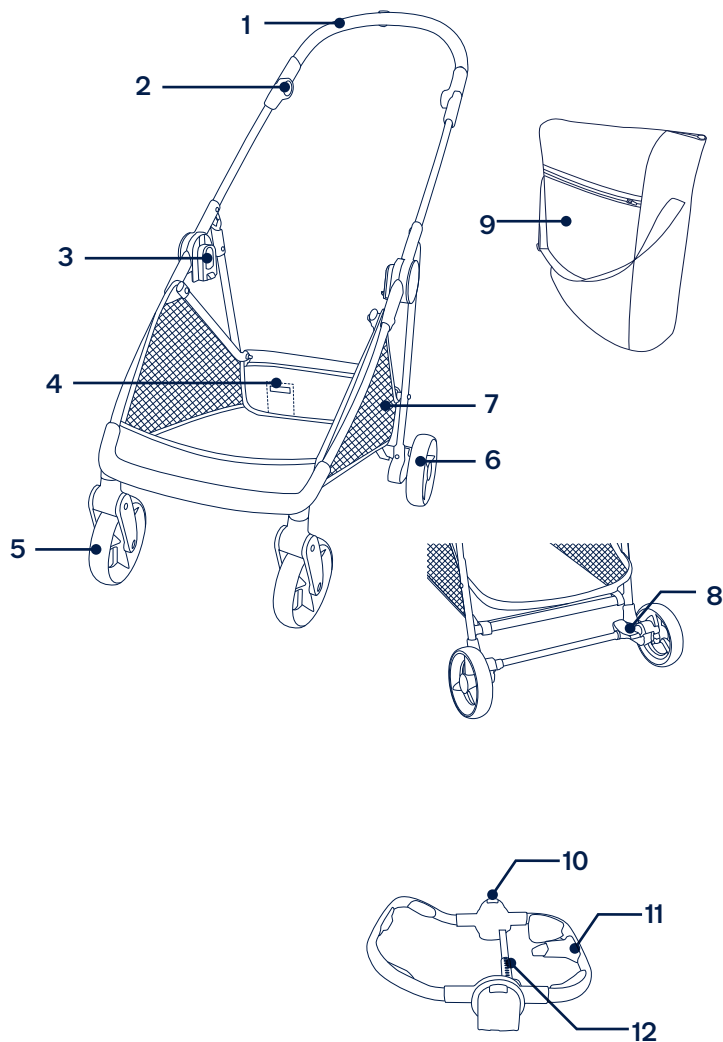

Product Setup and Fold

Open Stroller Frame

- 1 - Rotate the handle up to open the stroller frame.
- 2 - A “click” sound means the seat is open.

Fold Stroller Frame

The stroller can be folded with forward facing seat or rear facing seat or without the seat.

- 3 - Fold the stroller frame, press the folding buttons of the seat mounts.
- 4 - The stroller frame can stand after folded.

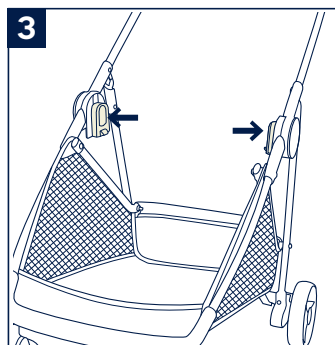
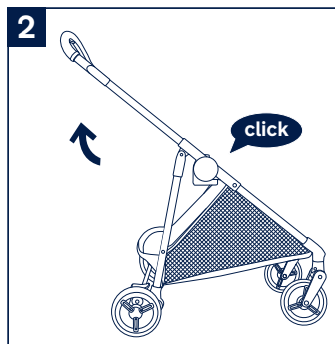
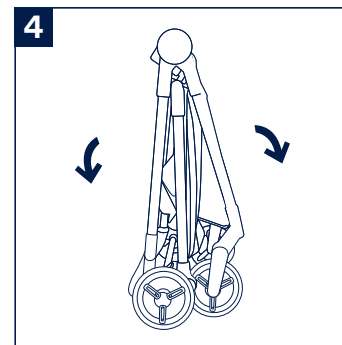
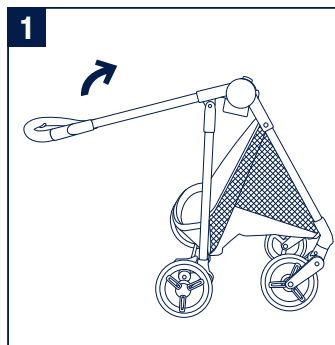

Product Use

Brake

- 1 - To lock wheels, press the rear end of the brake lever downwards.
- 2 - To release wheels, press the front end of the brake lever downwards.

Adjust Handle

⚠ Handle can be adjusted to 3 positions.

- 3 - To adjust the handle, press the left and right handle adjustment buttons at the same time (1), and rotate the handle to a desirable position (2).

⚠ Before folding the stroller, please adjust the handle to the second position. The stroller can stand after folding.

Tracking Device Pocket

- 4 - Insert tracking device (tracking device not included) into pocket in basket.

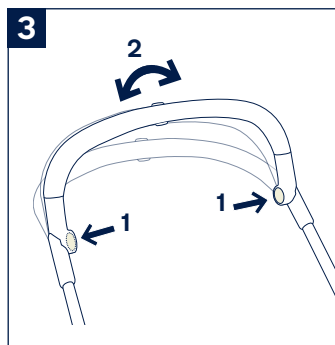
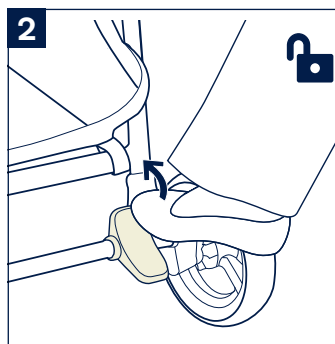
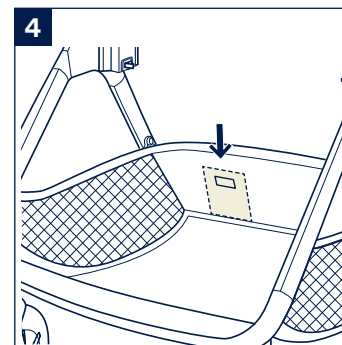
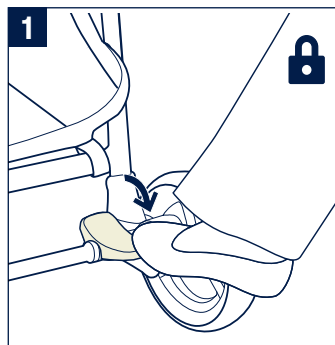

Car Seat Ring Adapter

Use the car seat ring adapter only with a Nuna PIPA™ series infant carrier in combination with a Nuna Flex System stroller frame.

See PIPA™ series infant carrier instruction manual for proper usage of the infant carrier.

- 1** - To attach the car seat ring adapter, place the ring adapter on the seat mount. A “click” sound means the ring adapter is attached.
- 2** - To attach the infant carrier, place the infant carrier on the ring adapter. A “click” sound means the infant carrier is attached.
- ⚠** Pull up on the infant carrier to check that it is securely attached to the adapter and that the adapter is securely attached to the stroller.
- 3** - The ring adapter can be attached so that the infant carrier is rear facing or forward facing.
- 4** - To remove the infant carrier, squeeze the release button located on the back of the infant carrier (**1**) and lift up (**2**).
- ⚠** Remove the infant carrier before folding.
- 5** - To fold the stroller with the ring adapter attached, pull the adapter fold strap.
- 6** - To remove the ring adapter (with the stroller unfolded), push the adapter release buttons (**1**) and lift the adapter up (**2**).

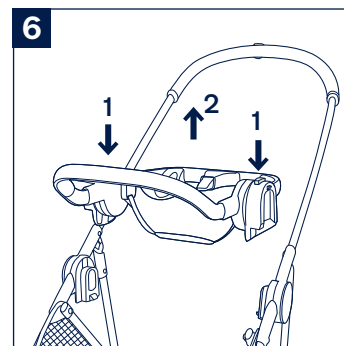
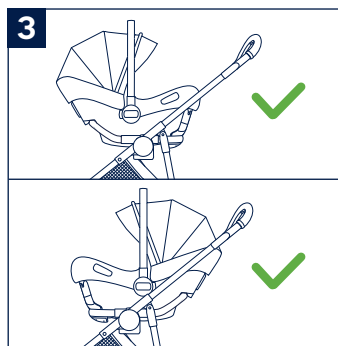
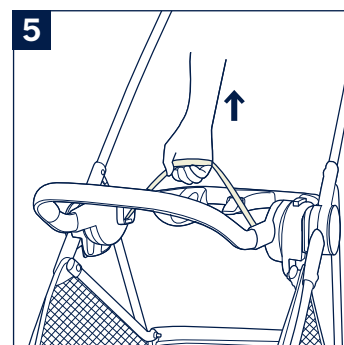
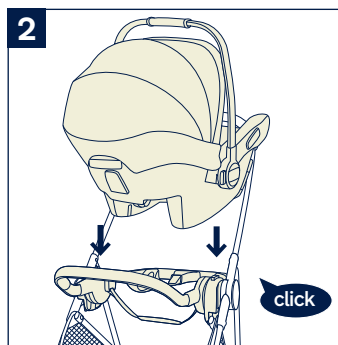
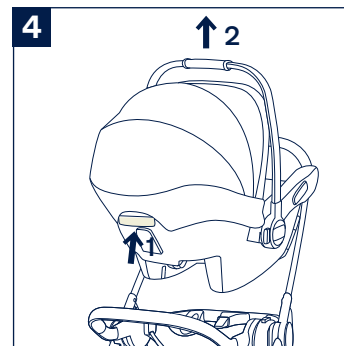
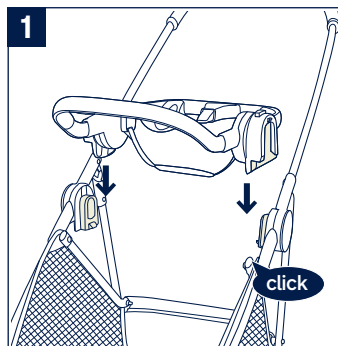

Accessories

Not all accessories are included on some models.

Carry Bag

- 1 - Put the folded stroller and ring adapter into the carry bag and zip the bag. The bag can be carried by the carry strap.

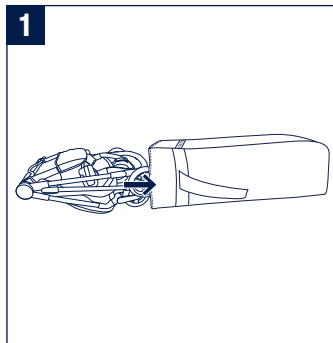

Cleaning and Maintenance

Refer to the care label attached to the fabric for washing and drying instructions.

Clean the frame, plastic parts, and fabric with a damp cloth, but do not use abrasives or bleach. Do not use silicone lubricants as they will attract dirt and grime. Do not store your stroller in a damp place.

Clean the stroller wheels regularly with water and remove any dirt.

To ensure long-lasting use, wipe off this product with a soft, absorbent cloth after using it in rainy weather.

It is normal for fabric to fade from sunlight and to show wear and tear after a long period of use, even when used normally.

For reasons of safety, only use original Nuna parts.

Check regularly if everything functions properly. If any parts are torn, broken, or missing, stop using this product.

IM-001464B



Nuna Baby Essentials, Inc.

70 Thousand Oaks Blvd. | Morgantown, PA 19543

1.855.NUNA.USA | nunababy.com